

Ceiling Trims - Shadow Curve Trim

Keynote Legend	
Key Value	Keynote Text
C3.1.	Supply and install Pelican Systems Vinyl or Pelican Systems Knauf Ceiling Solutions (KCS) ceiling tiles sizes (1200 x 600mm) or (600 x 600mm) x 9 / 12 / 15mm, laid onto Pelican Systems econogrid consisting of econogrid. Space econogrid Main Tees at 1200mm centres. Suspend Main Tees using 2.5mm thick pre-stretched Galvanised Hanger Wire or 19mm Hanger Strap at 1200mm centres. Galvanised Hanger Wire shall be put through the Main Tees hole and wound three times around itself. Two Steel Pop Rivets or one 13mm Wafer Tek Screw shall be used to fix the Hanger Strap to the Main Tees bulb
TR13	Supply and fit white epoxy coated aluminium Pelican Shadow Curve Trim with 16mm radiused supawood with 5 x 25mm anchors at 300mm centres

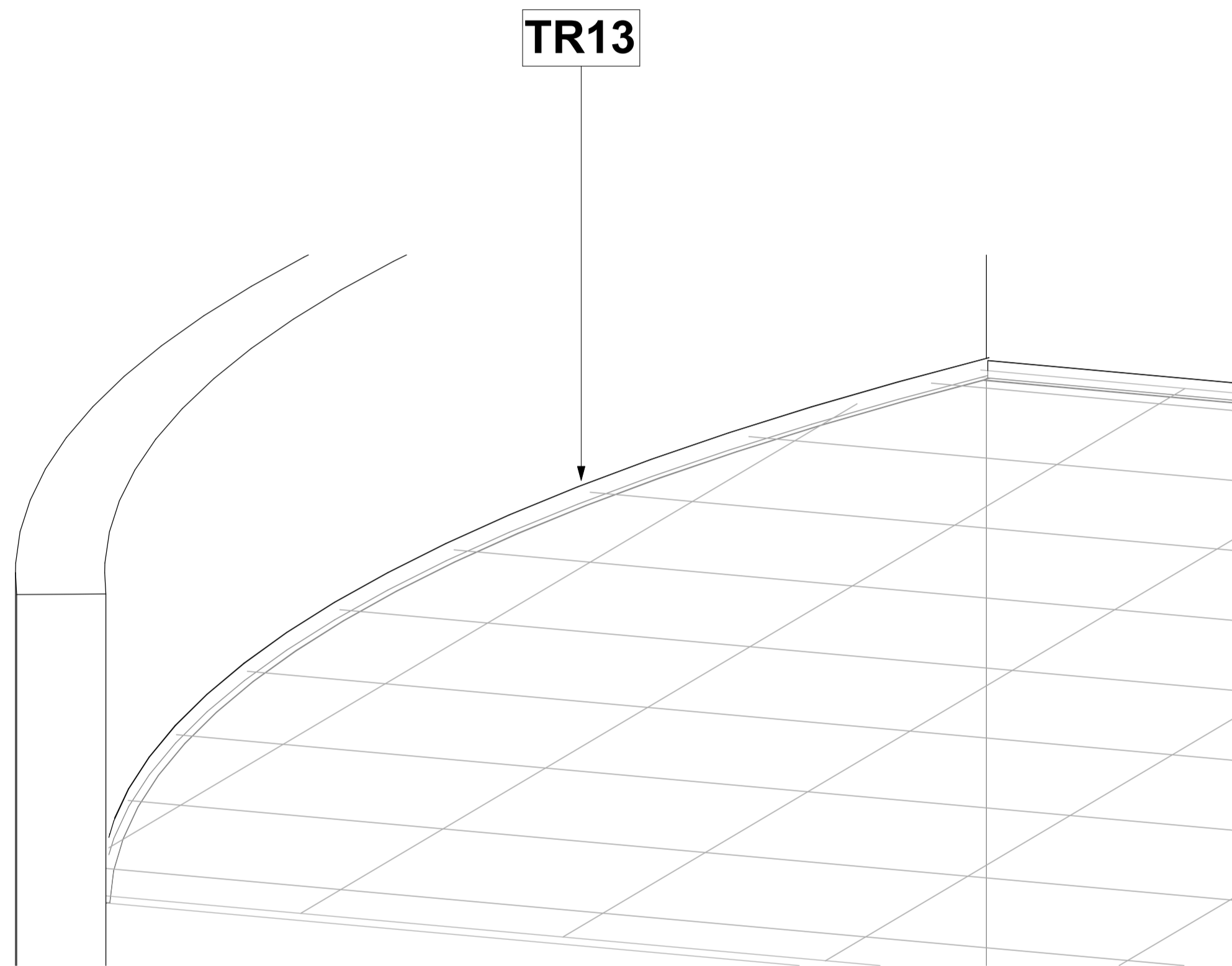

TR13 - Shadow Curve Trim - 3D
Scale

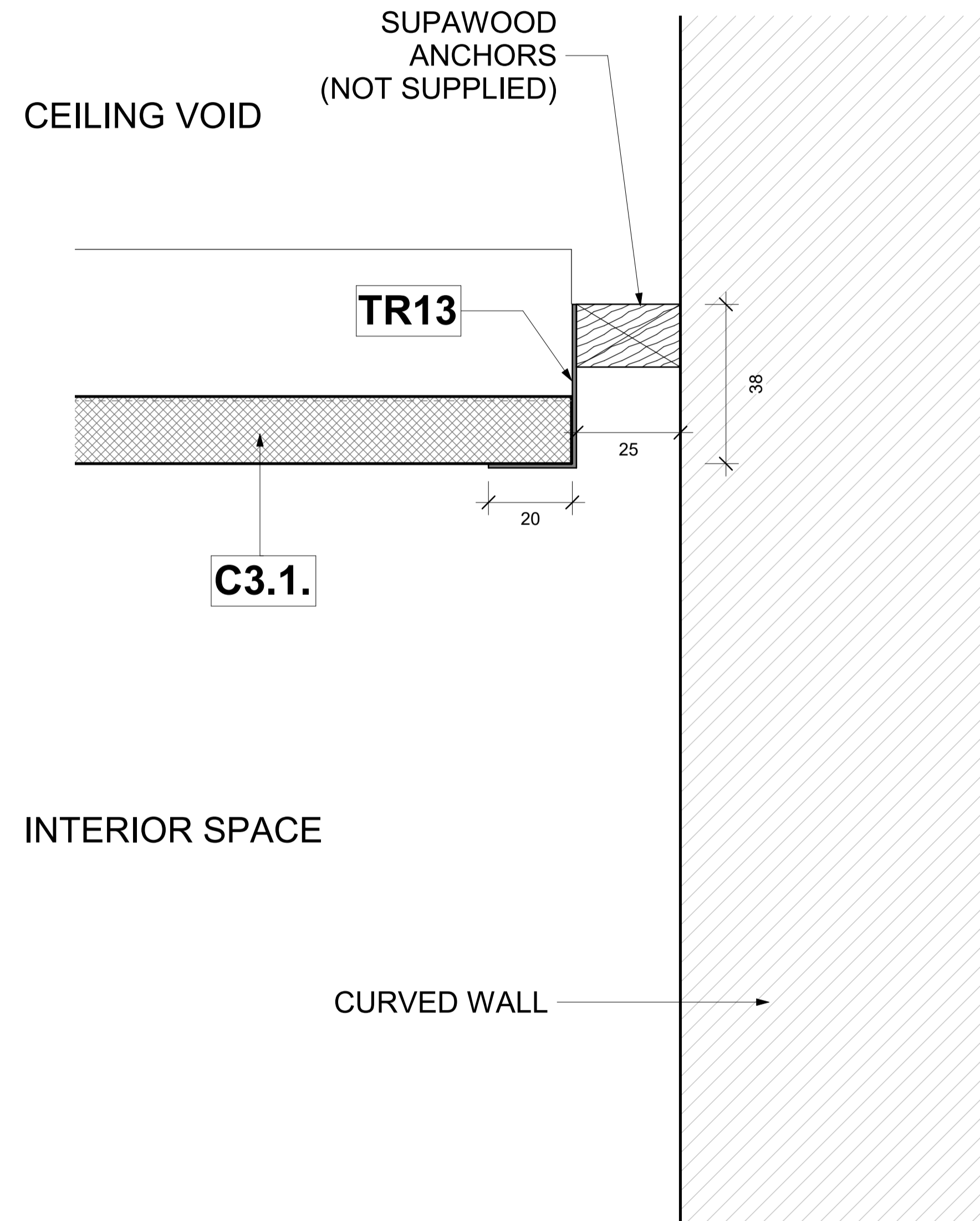

TR13 - Shadow Curve Trim - Section
Scale 1 : 1

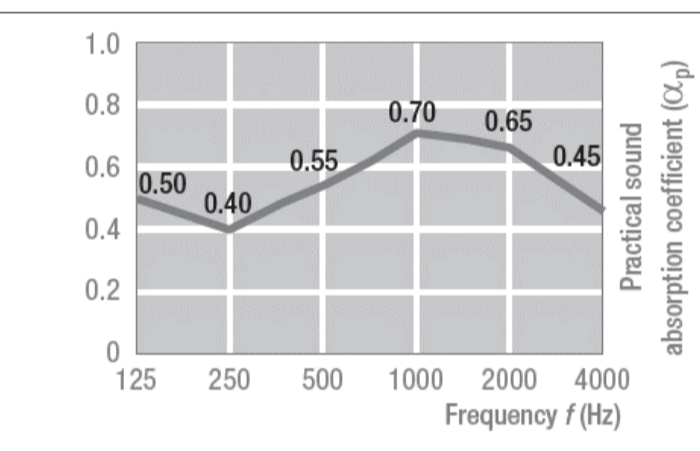
TR13 - Ceiling Trims - Shadow Curve Trim	
System	Ceiling Trims
Type of Product	Shadow Curve Trim
Recommended Areas	A ceiling profile designed to facilitate a radius wall with an exposed suspended ceiling. Used with 16mm radiused Supawood to create a Shadowline on the perimeter.
Technical Spec	38mm x 20mm
Material	Aluminium & Powder Coating
Picture	
Size and Thickness	4.0m
Colour Options	White
Building material information	N/A
Fire Protection	N/A
Sound absorption	N/A
Sound attenuation	N/A
Sound insulation	N/A
Practical sound absorption coefficient (α _p)	
Light reflectance	N/A
Thermal conductivity	N/A
Air permeability	N/A
Humidity	N/A
Green Rating	N/A
Specifications	Supply and fit white epoxy coated aluminium Pelican Shadow Curve Trim with 16mm radiused supawood with 5 x 25mm anchors at 300mm centres
Notes	



pelican systems
ceiling and partitioning specialists...

Head Office / Durban Branch | 765 / 793 Chris Hani Road, Durban, Redhill | 031 563 7307

Find us online at www.pelican.co.za or any of these social media sites 