

TR10 - Fascia Trim - 3D

Scale

Keynote Legend	
Key Value	Keynote Text
C2.3	Supply and install 3600mm JUMBO Main Tees at 1200mm centres in one direction and 1200mm JUMBO Cross Tees at 600mm centres perpendicular to Main Tees. Main Tees to be suspended at 1200mm centres by means of 25 x 25 x 0.6mm galvanised steel angle, hangers fixed to bulb of Main Tee with wafer tek screws/steel pop rivets and to slab with 6 x 30mm express nails and washers.
C4	Bulkhead Ceiling As Per Finishing Schedule and To Later Detail.
TR10	Supply and fit white epoxy coated aluminium Pelican Fascia Trim between horizontal ceiling and vertical bulkhead, vertical stand to be 16mm chipboard or supawood. Suspend Fascia Trim from slab at 1200mm centres with 38 x 25 x 0.8mm G.M.S angles.

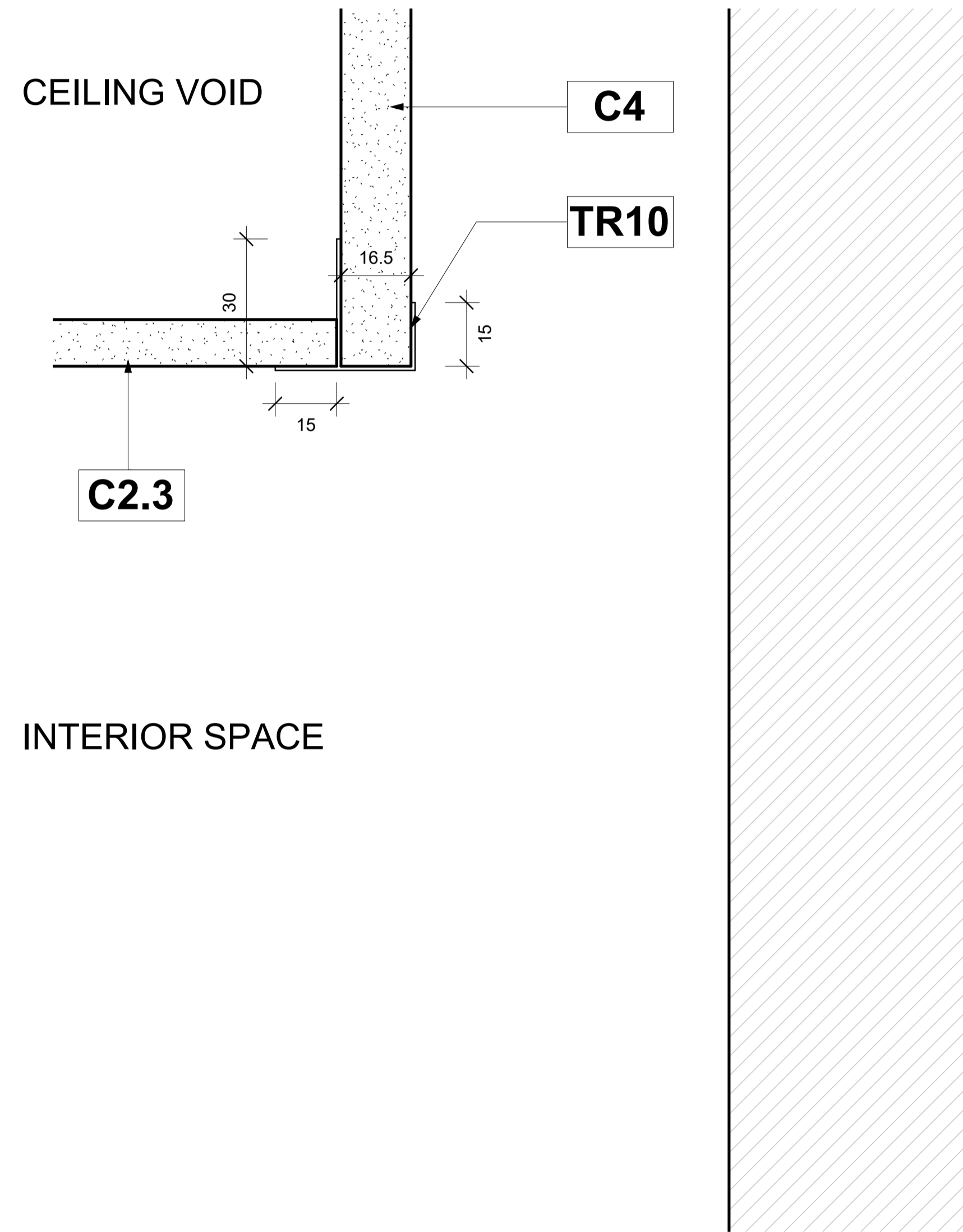

TR10 - Fascia Trim - Section

Scale 1 : 1

TR10 - Ceiling Trims - Fascia Trim	
System	Ceiling Trims
Type of Product	Fascia Trim
Recommended Areas	A ceiling profile designed to facilitate a vertical bulkhead at the edge of a suspended ceiling, especially against windows.
Technical Spec	Vertical Bulkhead
Material	Aluminium & Powder coating
Picture	
Size and Thickness	4.0m
Colour Options	White
Building material information	N/A
Fire Protection	N/A
Sound absorption	N/A
Sound attenuation	N/A
Sound insulation	N/A
Practical sound absorption coefficient (α _p)	
Light reflectance	N/A
Thermal conductivity	N/A
Air permeability	N/A
Humidity	N/A
Green Rating	N/A
Specifications	Supply and fit white epoxy coated aluminium Pelican Fascia Trim between horizontal ceiling and vertical bulkhead, vertical stand to be 16mm chipboard or supawood. Suspend Fascia Trim from slab at 1200mm centres with 38 x 25 x 0.8mm G.M.S angles.
Notes	



pelican systems
ceiling and partitioning specialists...

Head Office / Durban Branch | 765 / 793 Chris Hani Road, Durban, Redhill | 031 563 7307

Find us online at www.pelican.co.za or any of these social media sites