

JUMBO DryWALL 63/30/S44 (Insulated)

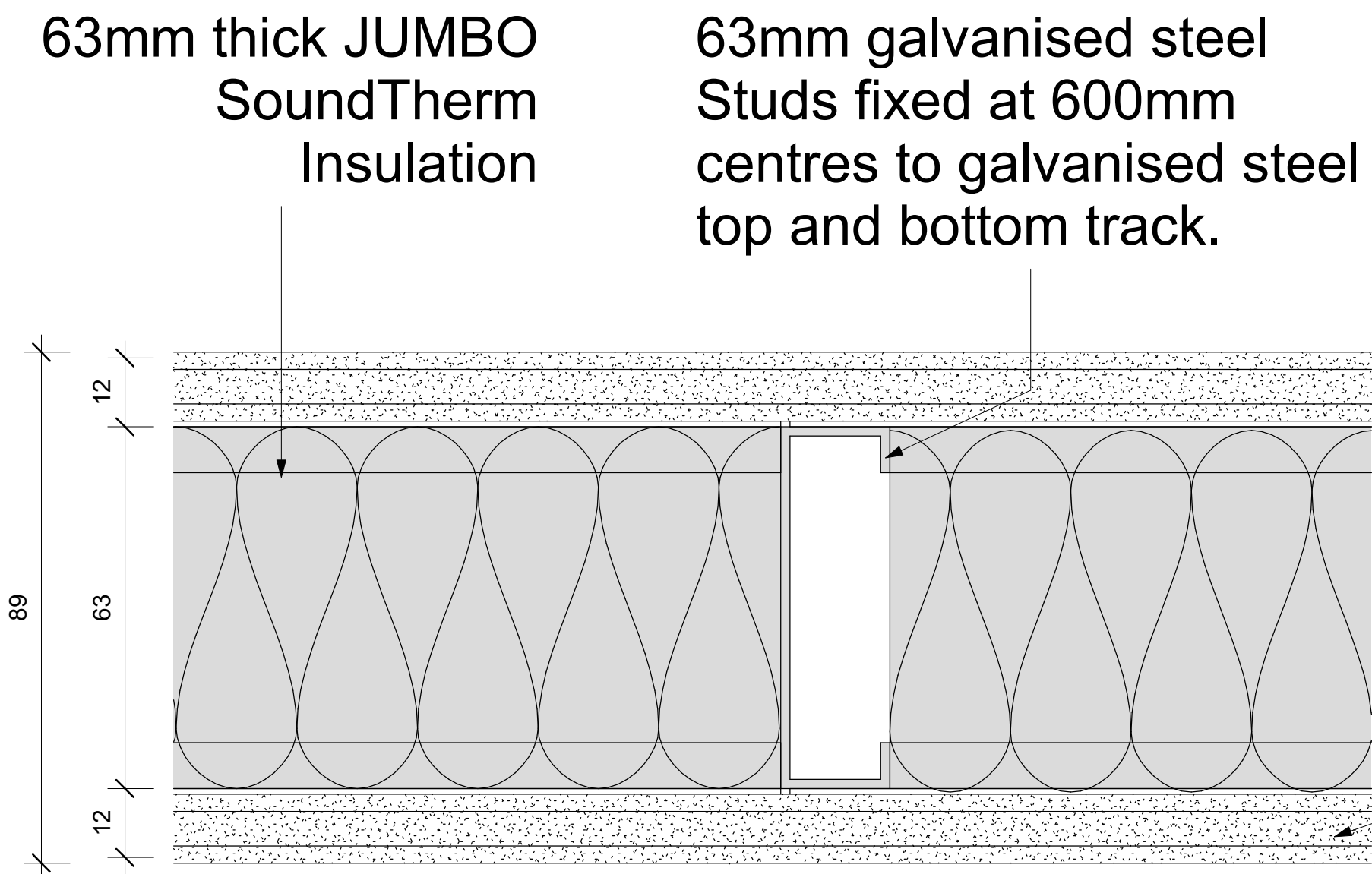

PW05 - JUMBO DryWALL 63/30/S44 (Insulated) - PLAN
Scale 1 : 1

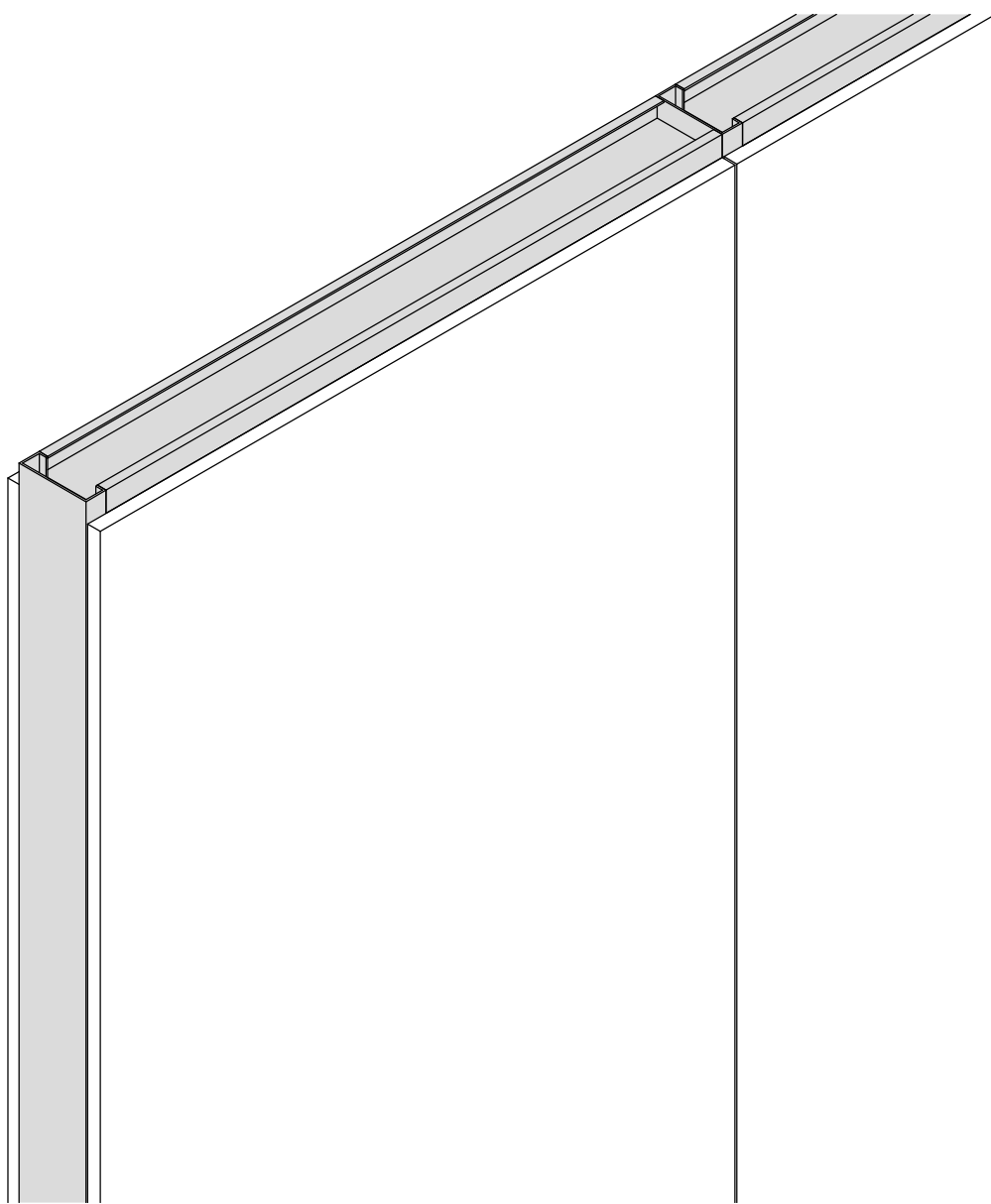

PW05 - JUMBO DryWALL 63/30/S44 (Insulated) - 3D
Scale

12mm thick JUMBO Plaster Boards in single lengths to suit height, butt jointed and secured to Studding with 25mm drywall screws at maximum 220mm centres

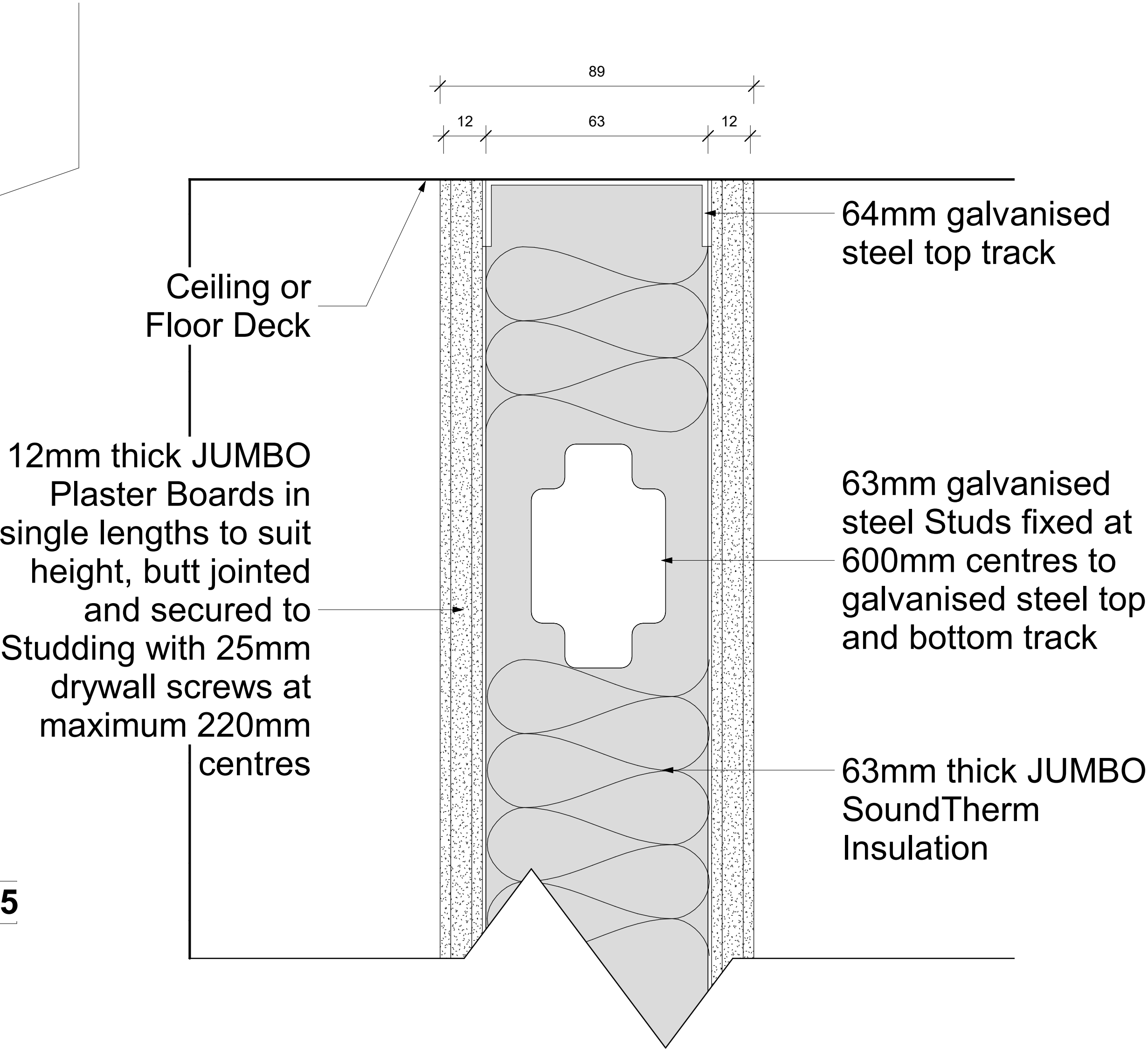

PW05 - JUMBO DryWALL 63/30/S44 (Insulated) - SECTION
Scale 1 : 1

Keynote Legend	
Key Value	Keynote Text
PW05	Pelican Systems JUMBO DryWALL 63/30/S44 with overall thickness of 89mm comprising internal framing formed of 63mm galvanised steel Studs fixed at 600mm centres to galvanised steel top and bottom Track with 63mm thick JUMBO SoundTherm Insulation in the cavity of the of the partition, including any additional steel Studding necessary at door openings, glazed or other apertures, abutments, ends, corners, etc. and covered with 12mm thick JUMBO plasterboards in single lengths to suit height, butt jointed and secured to Studding with 25mm JUMBO Drywall Screws at maximum 220mm centres, the joints taped over and flushed over with JUMBO jointing compound prepared for painting

PW05 - JUMBO DryWALL 63/30/S44 (Insulated)															
System	Partitions														
Type of Product	JUMBO DryWALL 63/30/S44 (Insulated)														
Recommended Areas	Offices / Light weight Solution / Dry Areas														
Technical Spec	* 63mm Stud and Track * 63mm JUMBO SoundTherm * 12mm JUMBO Board on each side of Stud and Track														
Material	0,45mm Galvanized Steel with Z100 Coating														
Picture															
Overall Thickness	89 mm														
Colour Options	To be painted.														
Building material information	N/A														
Fire Protection	30 Minute Fire Rating														
Sound absorption	N/A														
Sound attenuation	44db														
Sound insulation	N/A														
Practical sound absorption coefficient (α _p)	<table><thead><tr><th>Frequency f (Hz)</th><th>Practical sound absorption coefficient (α_p)</th></tr></thead><tbody><tr><td>125</td><td>0.50</td></tr><tr><td>250</td><td>0.40</td></tr><tr><td>500</td><td>0.55</td></tr><tr><td>1000</td><td>0.70</td></tr><tr><td>2000</td><td>0.65</td></tr><tr><td>4000</td><td>0.45</td></tr></tbody></table>	Frequency f (Hz)	Practical sound absorption coefficient (α _p)	125	0.50	250	0.40	500	0.55	1000	0.70	2000	0.65	4000	0.45
Frequency f (Hz)	Practical sound absorption coefficient (α _p)														
125	0.50														
250	0.40														
500	0.55														
1000	0.70														
2000	0.65														
4000	0.45														
Light reflectance	N/A														
Thermal conductivity	N/A														
Air permeability	N/A														
Humidity	N/A														
Green Rating	N/A														
Specifications	Pelican Systems JUMBO DryWALL 63/30/S44 with overall thickness of 89mm comprising internal framing formed of 63mm galvanised steel Studs fixed at 600mm centres to galvanised steel top and bottom Track with 63mm thick JUMBO SoundTherm Insulation in the cavity of the of the partition, including any additional steel Studding necessary at door openings, glazed or other apertures, abutments, ends, corners, etc. and covered with 12mm thick JUMBO plasterboards in single lengths to suit height, butt jointed and secured to Studding with 25mm JUMBO drywall screws at maximum 220mm centres, the joints taped over and flushed over with JUMBO jointing...														
Notes	The specification is based on a height restriction of up to 3.6 Metres high.														



pelican systems
ceiling and partitioning specialists...

Head Office / Durban Branch | 765 / 793 Chris Hani Road, Durban, Redhill | 031 563 7307
Find us online at www.pelican.co.za or any of these social media sites

