



DRAWING DETAIL

partitioning systems

**JUMBO MoistureWALL 63/112
CORNER DETAIL**

Front side - 12mm JUMBO® Fire Resistant Plasterboard fixed to JUMBO® Drywall Steel Stud using 25mm JUMBO® Drywall screws at maximum 220mm centers.

Opposite side - 12mm JUMBO® Moisture Resistant Plasterboard fixed to JUMBO® Drywall Steel Stud using 25mm JUMBO® Drywall screws at maximum 220mm centers. All joints to be staggered. The joints taped over and flushed over with JUMBO® Jointing Plaster prepared for painting.

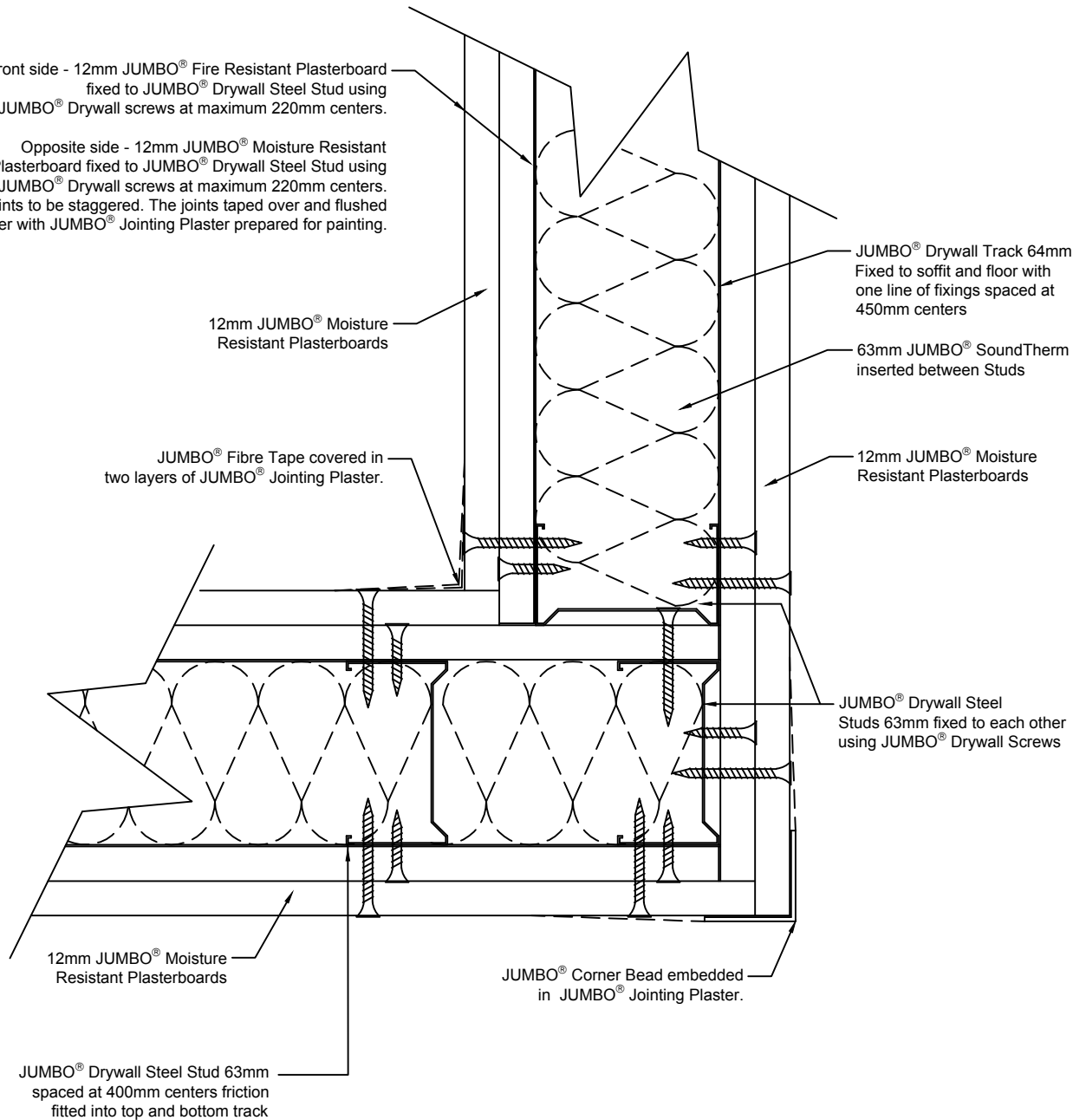

12mm JUMBO® Moisture Resistant Plasterboards

JUMBO® Fibre Tape covered in two layers of JUMBO® Jointing Plaster.

12mm JUMBO® Moisture Resistant Plasterboards

JUMBO® Drywall Steel Stud 63mm spaced at 400mm centers friction fitted into top and bottom track

JUMBO® Corner Bead embedded in JUMBO® Jointing Plaster.

JUMBO® Drywall Track 64mm Fixed to soffit and floor with one line of fixings spaced at 450mm centers

63mm JUMBO® SoundTherm inserted between Studs

12mm JUMBO® Moisture Resistant Plasterboards

JUMBO® Drywall Steel Studs 63mm fixed to each other using JUMBO® Drywall Screws

Details to be used for information purposes only.

DRAWING NO.

Corner detail - REV 1

NOTES:

To be read in conjunction with the project specifications